

RISTRETTO

Owner's Handbook | Assembly & Maintenance

RISTRETTO

Certificate of Identity and Warranty

303FS Founders Edition

Model

Detroit Bikes, Detroit, MI

Manufacturer Details

Ristretto Electric, Denver, CO

Design

July 1st, 2022

Start Date of Warranty

Color

Serial No.

Located on the seat tube of your 303FS.

Owner's Handbook

Assembly & Maintenance



Welcome to Ristretto.

Thank you for choosing Ristretto and your purchase of the 303FS Founders limited-edition bike.

Your electric bike was manufactured in Detroit, Michigan by one of the best artisan bike engineers in North America, Detroit Bikes. It is important for us to follow this same tradition of excellence for all Ristretto products. Your 303FS bike has been quality crafted and is feature-rich, optimized to provide you with an elevated riding experience.

Our number one priority is to ensure your safety and the best riding performance possible.

Important: please read and understand this manual first before assembling and operating your Ristretto bike. We recommend having your bike professionally assembled by a certified electric vehicle mechanic.

The 303FS is a high performance electric bike, designed for experienced riders. Please ride responsibly.

If you have questions after reading this manual, please reference the Ristretto Electric Help Center, or contact us by email at: Info@ristrettoelectric.com or via Ristretto Discord community.

We would love to hear from you.

Stay Electric

I General Information

This manual contains warnings and cautions that are marked by the triangular caution symbol and should be given special attention to the information marked in this owner's manual.

If you have questions after reading this manual, please reference the Ristretto Help Center.

Keep this manual, along with any other documents that were included with your bike, for future reference. All content in this manual is subject to change so please be sure to visit ristrettoelectric.com/ownershandbook to view and download the latest version. Ristretto makes every effort to ensure the accuracy of its documentation is correct and assumes no responsibility of liability if any errors or inaccuracies appear within.

Assembly and the first adjustment of your 303FS requires special tools and skills, therefore it is recommended that you have your bike assembled by a certified, electric bike mechanic or a mobile assembly service provider like velofix.com. Riding an incorrectly assembled bike can put your and others' safety at risk.

There are risks associated with the use of any bike which cannot be predicted or avoided and are the sole responsibility of the rider. Please ride responsibly.

PLEASE NOTE: THIS MANUAL IS NOT INTENDED AS A DETAILED USER, SERVICE, REPAIR OR MAINTENANCE MANUAL. PLEASE SEEK ASSISTANCE FROM A QUALIFIED TECHNICIAN FOR SERVICE, REPAIRS OR MAINTENANCE. YOUR INSURANCE POLICIES MAY NOT PROVIDE COVERAGE FOR ACCIDENTS INVOLVING THE USE OF THIS BICYCLE.

I Table of Contents

General Information _____	2	Mode and Class Selection _____	17
303FS Diagram _____	4	Advanced Controller Display Settings _____	18
Assembly Instructions _____	5	Operating Integrated Lights _____	19
Step 1: Unbox and Install Front Wheel _____	5	Powering Off the Motor _____	19
Step 2: Install Handlebar _____	7	Ristretto App _____	20
Step 3: Install Pedals _____	7	How to Connect the Mobile App _____	20
Step 4: Inflate Tires _____	9	Change Riding Modes _____	21
Step 5: Charge Battery Pack _____	9	Troubleshooting	
Battery _____	10	Error Codes _____	22
How To Remove Battery Pack _____	10	Troubleshooting _____	23
Battery Charging Information _____	10	Checklist	
Operating Instructions _____	12	Pre-Ride Checklist _____	26
Powering On _____	12	Post-Ride Checklist _____	27
Display Set Up _____	13	Maintenance Checklists _____	28
Braking Procedure _____	14	Warranty	
Pedal Assist Level Settings _____	15	Limited Warranty & Other Terms _____	29
Basic Controller Display Settings _____	16		

303FS Diagram

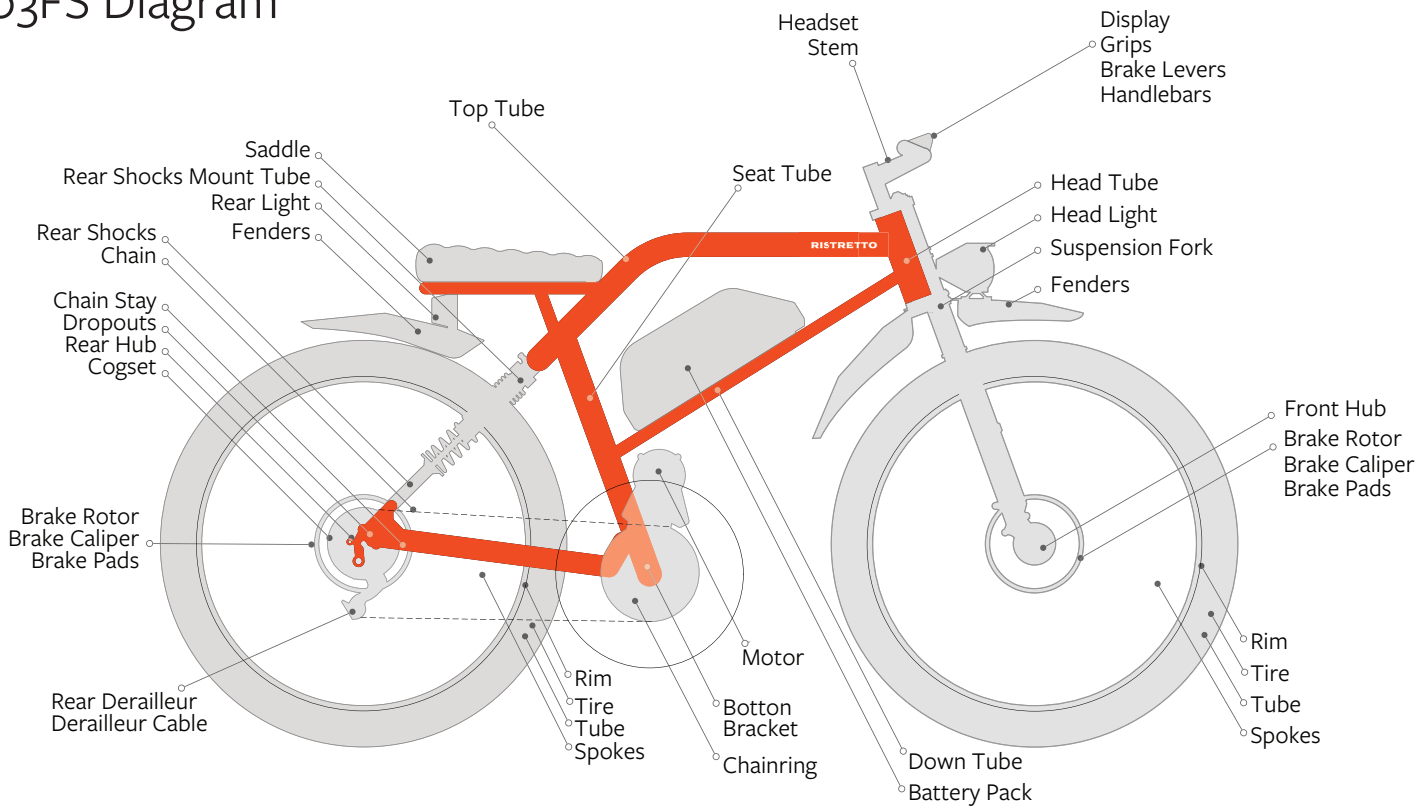

I Assembly Instructions

STEP 1: UNBOX AND INSTALL FRONT WHEEL

Carefully open the bike box fasteners then remove the owner's tool box.

Owner's Tool Box Contents:

- Owner's Manual
- Battery Lock Keys (2x)
- Battery Charger
- Pedal Set
- Pedal Wrench
- Multi Tool (can be used instead of a torque wrench if needed)



UNBOXING AND BIKE ASSEMBLY IS HIGHLY RECOMMENDED TO BE COMPLETED BY TWO PEOPLE THAT ARE CAPABLE OF LIFTING A HEAVY OBJECT SAFELY.

1. Lay down a soft floor covering to protect the bike forks and your floor.
2. Remove the front wheel from the box to prepare for installation.
3. Remove packaging material then carefully lift the bike out from both sides.
4. Place the bike on the soft floor covering with one person holding the bike upright.

5. With one person holding the bike upright, remove one fastener from the front axle using an M6 hex key, then slide the front axle out from the front forks.
6. With one person holding the bike upright, prepare to slide the front wheel between the front forks:
 - a. Remove the front brake caliper spacer.
 - b. Carefully align the wheel brake rotor to slide between the brake caliper pads.
 - c. Align the front wheel hub with the fork axle holes.
 - d. Gently slide the axle through the fork axle holes and through the front wheel hub.
 - e. Hand thread the second axle fastener on the front axle.
 - f. Torque the axle fasteners (2x) using an M6 hex key (15 Nm)
 - g. Torque fork axle pinch fasteners (4x) using an M5 hex key (10 Nm)



PLEASE USE A TORQUE WRENCH IF POSSIBLE. BE CAREFUL NOT TO CROSS-THREAD OR DAMAGE THE FASTENER THREADS.

7. With one person holding the bike upright, spin the front wheel to ensure proper alignment. Make sure the front brake rotor is properly aligned between the brake caliper pads.



A PROPERLY INSTALLED FRONT WHEEL SHOULD SPIN FREELY. IF YOU HAVE ANY HESITATION, PLEASE CONTACT A CERTIFIED EV MECHANIC FOR ASSISTANCE.

Please be kind to the environment and be sure to recycle all packaging materials according to your local guidelines.

STEP 2: INSTALL HANDLEBAR

1. Remove the bolts of the handlebar clamp using an M5 hex key.
2. Place the lower crossbar of the handlebar in the groove of the top crown once the clamp is open.
3. Finger tighten the handlebar clamp, then adjust the angle of the handlebar to the rider's preference.
4. Torque the stem clamp fasteners using an M5 hex key (10 Nm) in a cross pattern making sure the clamp is tight and the handlebars do not move.

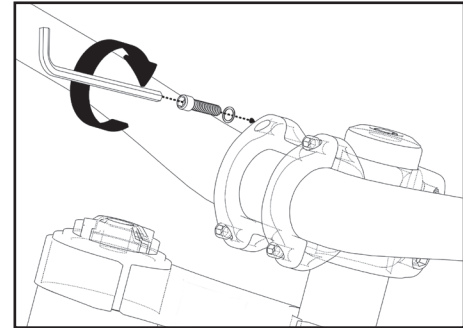
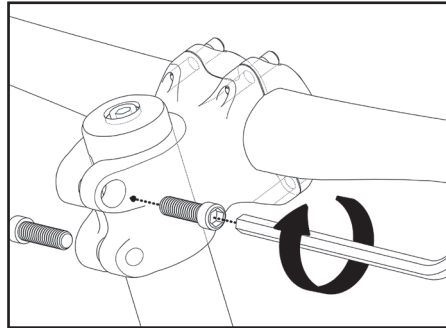
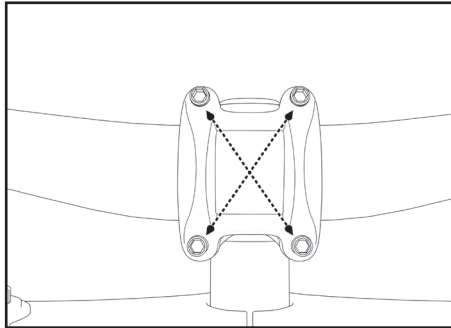

STEP 3: INSTALL PEDALS

1. Locate the Right side pedal (stamped with an “R” at the end of the pedal axle). The Right side pedal goes on the crank on the Right side of the bike (the side with the drivetrain gears). Torque each pedal to (35 Nm). Use the included pedal wrench to avoid damage caused by wider wrenches.

- a. The Right side pedal is tightened by threading it clockwise.
Carefully thread the Right pedal onto the crank on the Right side of the bike slowly and by hand.
- b. The Left side pedal is reverse-threaded and tightens counter-clockwise (stamped with an “L” at the end of the pedal axle). Carefully thread the pedal onto the Left crank by hand slowly.

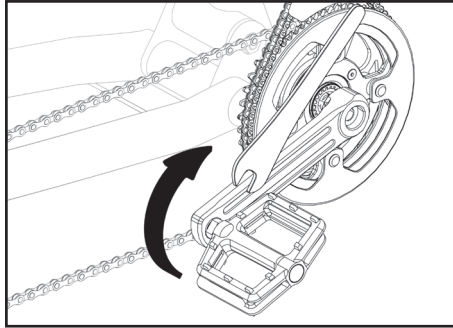

Right side pedal

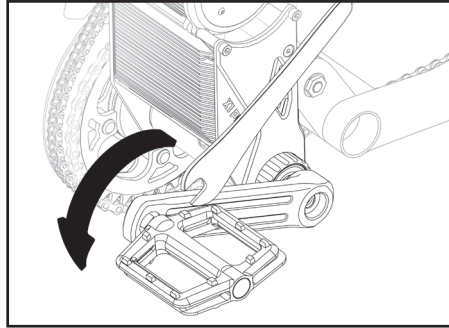

Left side pedal



BE CAREFUL NOT TO CROSS-THREAD OR DAMAGE THE THREADS.



WARNING

CROSS-THREADING OR IMPROPER PEDAL INSTALLATION CAN CAUSE IRREVERSIBLE DAMAGE TO THE CRANK ARM THREADS. INSTALL WITH CARE.

STEP 4: INFLATE TIRES

1. Check that the tires and tire beads are evenly seated around the rims.
2. Use a bike pump with a Schrader valve and pressure gauge to inflate each tire to the recommended air pressure indicated on the tire sidewall.



DO NOT OVER INFLATE OR UNDER INFLATE THE TIRES.

STEP 5: CHARGE BATTERY PACK

1. Ensure the battery is switched off.
2. Plug the charger into the battery charging port. With the battery on or off the bike, place the charger in a flat, secure place, and connect the DC output plug from the charger (round 3-pin connector) to the charging port on the side of the battery.
3. Plug the charger into a power outlet. Connect the charger input plug to the power outlet. Charging should initiate and will be indicated by the LED charge status light on the charger turning red.
4. Once fully charged the LED charge status light will turn green. Unplug the charger from the wall outlet first and proceed to remove the charger output plug from the battery charging port.

| Battery

HOW TO REMOVE BATTERY PACK

- Insert battery key into battery lock.
- Rotate key counter-clockwise to unlock.
- With both hands, carefully slide battery pack forward and lift it off of the battery cradle.



WARNING

ALWAYS CHARGE YOUR BATTERY IN TEMPERATURES BETWEEN 10 °C - 25 °C (50 °F - 77 °F) AND ENSURE THE BATTERY AND CHARGER ARE NOT DAMAGED BEFORE INITIATING CHARGE. NEVER LEAVE A CHARGING BATTERY UNATTENDED. CHARGE ONLY IN A SAFE LOCATION.

BATTERY CHARGING INFORMATION

- Check the charger, cables, and battery for damage before beginning each charge.
- Always charge in a safe area that is indoors, cool, dry, away from direct sunlight, dirt and debris, in a low traffic area away from the potential to trip on the charging cords, or to cause damage to the bike, battery, or charging equipment while parked and/or charging. *Always charge your battery in temperatures between 10 °C - 25 °C (50 °F - 77 °F).
- The battery can be charged on or off the bike. To remove the battery, turn the key to the off and unlocked position, remove the key from the key port by pulling directly backwards without twisting, and then carefully pull the battery forward and up until the battery detaches from the receptacle. The battery should be recharged after each use, so that it is ready to go the full range for your next ride. There is no memory effect, so charging the battery after short rides will not cause damage.

- Charging the battery normally takes 4-7 hours. In rare cases, it may take longer to allow the battery management system to balance the battery, particularly when the bike is new or after long periods of storage. Balance the battery during the first three charges by leaving it connected to the charger for at least two hours after it is fully charged.
- The charge indicator lights will show two red lights while the battery charges. When charging is complete, one indicator light will turn green, so one green, and one red will be illuminated. Ensure the lights face upward when charging.
- Remove the charger from the battery after the green light indicates a complete charge. The charger is designed to automatically stop charging when the battery is full, but unnecessary wear of the charging components could occur if the charger is left attached to the battery and a power source for longer than 12 hours. Detach the charger as soon as possible once the green light indicates a complete charge to avoid unnecessary wear of charging components.
- Never charge a battery for more than 12 hours at a time.
- Do not leave a charging battery unattended.



CHANGE THE BATTERY ONCE EVERY MONTH IF YOUR BIKE HAS NOT BEEN IN USE.



WARNING

FAILURE TO FOLLOW THE BEST PRACTICES OUTLINED IN THE BATTERY CHARGING INFORMATION SECTION COULD RESULT IN UNNECESSARY WEAR TO THE CHARGING COMPONENTS, BATTERY, AND OR CHARGER, AND COULD LEAD TO AN UNDERPERFORMING OR NON-FUNCTIONAL BATTERY, REQUIRING REPLACEMENT THAT WILL NOT BE COVERED UNDER WARRANTY. FAILURE TO FOLLOW BATTERY SAFETY PROCEDURES MAY RESULT IN THE RISK OF FIRE OR EXPLOSION.



WARNING

DO NOT RIDE A BIKE THAT HAS NOT PASSED THE 100% SAFETY VERIFICATION. BEFORE EACH RIDE, CHECK THE BIKE AS DESCRIBED IN THE SECTION “PRE-RIDE SAFETY CHECK”. FOR HELP PLEASE VIEW THE RISTRETTO HELP CENTER AT WWW.RISTRETTOELECTRIC.COM/HELPCENTER

| Operating Instructions

POWERING ON

- Flip up the kickstand, squeeze the brake lever to engage the brakes and kick your leg over the saddle.
- When firmly seated on the bike, press the handlebar control power button to turn the bike on.

NOTE: The control power button needs to be pressed (2-3 seconds) to start-up/ power down.



NEVER SIT ON THE BIKE WITH THE KICKSTAND ENGAGED.



WARNING

ONCE THE DISPLAY SCREEN IS ILLUMINATED, THE THROTTLE AND PEDAL ASSIST IS LIVE. DO NOT TOUCH THE CHAINS, CHAINRINGS, MOTOR, COG, WHEELS, OR ANY MOVING PARTS WHILE THE MOTOR IS ACTIVATED.

I Display Set Up

Before your first ride, double check the basic display settings.

1. Turn on display & double press the Menu button to activate the settings menu
 - Press the Power button to enter basic settings menu
2. Select 'Wheel', then press the Menu button to select the wheel size
 - Make sure the 303FS wheel size is set to '**29 inch**' (for 26" fat tire diameter)
 - This will ensure accurate speedometer readings
3. Select 'Battery', then press the Menu button to select voltage setting
 - Make sure the 303FS battery voltage is set to '**52 V**'
 - This will ensure accurate battery capacity level readings
4. Press Menu again to set the changes and exit the settings navigation.

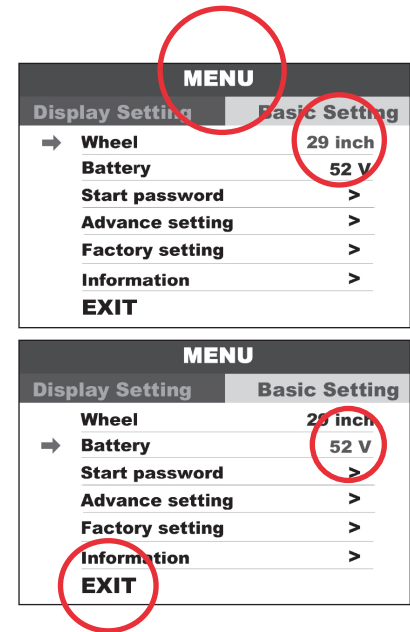

I Braking Procedure

The 303FS uses a four piston Tektro hydraulic brake system with large rotors. When used properly this system will give the rider a strong, safe and reliable stopping power. The Left lever will activate the front brakes when compressed and the Right lever will activate the rear brakes when compressed.

Front brake = Left Lever

Rear brake = Right Lever

In most cases when braking we recommend primarily squeezing the front brake lever while leaning your weight back in order to prevent the rear tire from losing traction.



WARNING

BRAKE HOSES AND CALIPERS MAY BE HOT AFTER A SHORT RIDE. DO NOT TOUCH THE BRAKE HOSES, CALIPERS, PADS OR ROTORS UNTIL THEY HAVE FULLY COOLED DOWN.

I Pedal Assist Level Settings

When the rider begins to pedal or turn the cranks, pedal assist sensors will activate the motor according to the pedal assist level settings.

1. Press the up (+) button to increase the pedal assist level.
2. Press the down (-) button to decrease the pedal assist level.
3. The 303FS comes set with 5 pedal assist levels:
 - a. Level 0 = 0%, pedal assist is turned off.
 - b. Level 1 = 30%
 - c. Level 2 = 45%
 - d. Level 3 = 60%
 - e. Level 4 = 80%
 - f. Level 5 = 100%

Basic Controller Display Settings

Double press the Menu button to activate the settings menu.

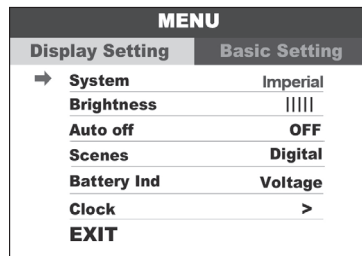

Press the Power button to change **Display Setting / Basic Setting**.

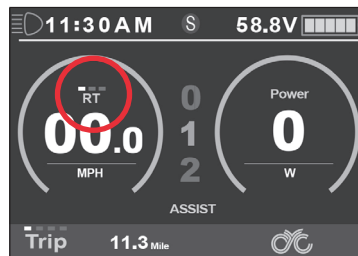

Mileage Mode Switch
Short Press Power button:
Trip - ODO - Time

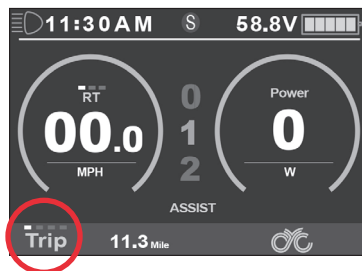

Speed Mode Switch
Short Press Menu button:
Speed - Avg Speed -
Max Speed

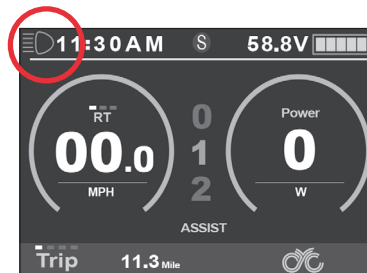

Screen Backlight On / Off
Press and hold the UP
button for 1 second

I Mode and Class Selection

- Double press POWER on your display to switch between **S (Street Mode)** and **R (Race Mode)**
- Restart your bike to activate mode.

NOTE: Switch between **S and R** mode by double pressing power button (need to restart to take affect). Please ignore all other settings.

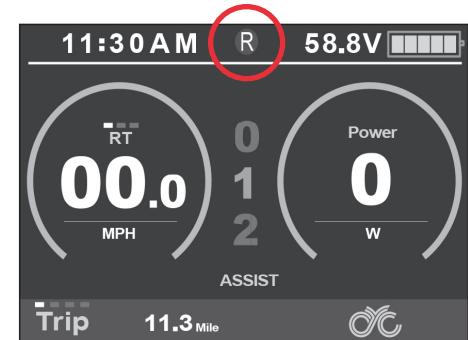
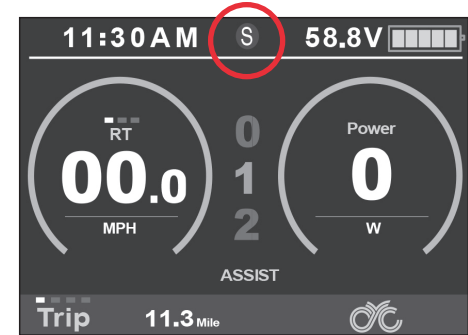

WARNING

R (RACE MODE) MODE IS FOR OFF-ROAD USE ONLY!



NOTE THAT R MODE (RACE MODE) IS FOR OFF-ROAD USE ONLY AND IS NOT LEGAL ON PUBLIC ROADS. USE AT OWN RISK AND DISCRETION. RISTRETTO WILL NOT BE HELD LIABLE FOR ANY DAMAGES INCURRED.

I Advanced Controller Display Settings (750c Display)

Double press the Menu button to activate the settings menu.

- Press Power button to change Display Setting / Basic Setting.
- Press Up / Down buttons to change the parameter setting.
- Press Menu button to switch to the next item.
- Double Press the Menu button to exit from menu.

MENU	
Display Setting	Basic Setting
➔ System	Imperial
Brightness	
Auto off	OFF
Scenes	Digital
Battery Ind	Voltage
Clock	>
EXIT	

System

- Press Up / Down to switch between Metric / Imperial.

Brightness

- Press Up / Down to change backlight brightness.
(I) is darkest, (|||||) is brightest.

Auto Off

- Press Up / Down button to change the auto power off time.

Battery Indicator

- Press Up / Down button to change Voltage / Percentage / Off.

Clock

- a. Press Menu button.
- b. Press Up / Down to set Year / Month / Day / Hour / Min / Sec.

I Operating Integrated Lights

The 303FS comes equipped with front headlights and a rear light.

- To activate the front headlight and rear light, flick the light switch to on.
- Follow the opposite step to turn the lights off.

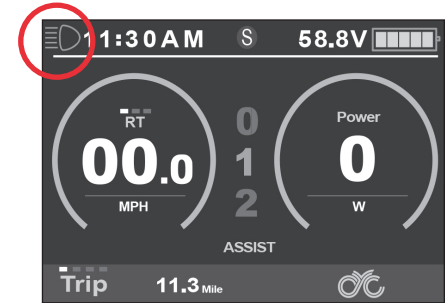

I Powering Off the Motor

It is important to turn off the power properly when you are finished riding.

- Press and hold the power button on the display.
- The display will turn off when properly powered down.

How to Connect the Mobile App



STEP 1 Download the App from the App Store or Google Play

STEP 2 Open Ristretto App & log in with your provided credentials

STEP 3 Select the Bluetooth[®] icon in the upper left corner

STEP 4 Select “Connect a new device”

STEP 5 Select eBike and then select “Connect”

* When returning to the home page, your Bluetooth[®] icon will be red when your ebike is connected.

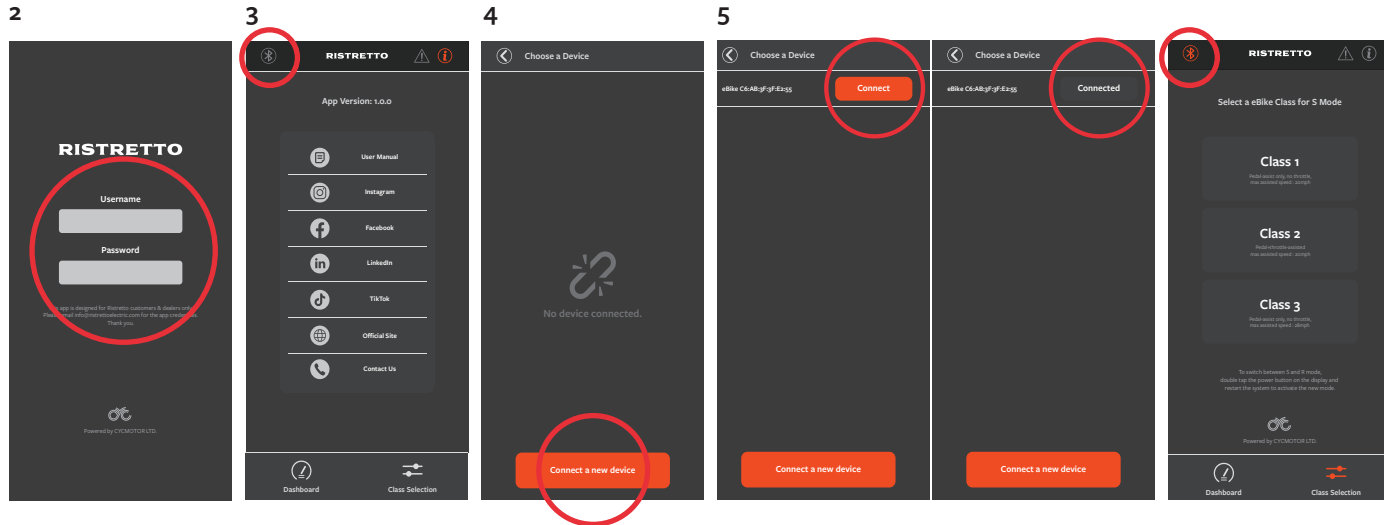

Change Riding Modes

Each 303FS bike comes programmed in the **Class-1** ride mode, which allows for throttle operation and pedal-assist riding up to 28mph. This allows your 303FS to be legally ridden without insurance, license, or registration.

Changing Riding Modes:

The 303FS EV offers multiple riding class mode selections. To change the riding mode, follow instructions detailed in the mobile app controlling your display.

Once in the App, you can change between the following riding modes:

Class 1 - pedal assist only at 20mph max speed (default class)

Class 2 - o throttle operation and pedal assist at 20mph max speed

Class 3 - pedal assist only, at 28 mph max speed

Race Mode* - up to 2500 watts of power and throttle speeds above 28mph

* Race Mode is exclusively for riding on private property and can only be accessed via the display (see pg. 17).

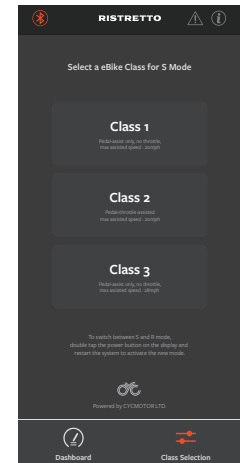

IT IS THE RIDER'S RESPONSIBILITY TO FOLLOW LOCAL EV LAWS, REGULATIONS, AND MOTOR VEHICLE CODES.



WARNING

NEVER ADJUST THE SETTINGS ON YOUR APP WHILE RIDING YOUR BIKE. BY OPERATING YOUR BIKE AND THE APP SIMULTANEOUSLY YOU PUT YOURSELF AT RISK FOR COLLISION AND SERIOUS INJURY TO YOU OR OTHERS. BE SURE TO PRACTICE SAFE RIDING PROCEDURES AND PULL OVER FIRST.

I Error Codes

ERROR CODE	ERROR DESCRIPTION	COMMON SOLUTION
Error 21H	Settings issue	Contact support line
Error 22H	Throttle error	Check the throttle cable connection
Error 24H	Hall sensor error	Check all cable connections
Error 30H	Communication error	Check the display cable connection

If an error code displays, be sure to note the number. First, try turning the bike off, then back on. If the error persists, turn off the bike and then stop touching it to ensure you aren't causing the error by accidentally pressing a button. Check our Help Center for detailed information on the error code.

APP WARNING	COMMON SOLUTION
Hall Sensor/ Hall Illegal sector	Check all cable connections
POST static gating test	Disconnect and reconnect all motor wires
Other error	Contact support line

I Troubleshooting

PROBLEM

COMMON SOLUTION

Bike doesn't work:

Insufficient battery power	Charge the battery
Battery not fully seated in tray	Install battery correctly
Faulty connections	Clean and reconnect connectors
Battery non-functional	Replace battery

Irregular acceleration and/or reduced top speed:

Insufficient battery power	Charge or replace battery
Loose or damaged throttle	Replace throttle
Loose or damaged motor plug wire	Reconnect or replace
Damaged motor	Replace

PROBLEM

COMMON SOLUTION

Reduced range:

Low tire pressure	Inflate tires to PSI stamped on sidewall
Low battery	Charge battery
Driving with too many hills, headwind, braking, or excessive load	Assist with pedals or adjust route
Battery discharged for long period without regular charges	Recharge the battery. If range decline persists, consult our Help Center
Brakes rubbing	Adjust the brakes
Faulty, damaged, or aged battery	Contact Ristretto Support to replace the battery. Disconnect and store damaged battery in a safe location and recycle or dispose of as soon as possible according to local rules.

PROBLEM**COMMON SOLUTION****The battery won't charge:**

Charger not properly connected	Adjust the connections
Charger damaged	Replace the charger
Battery damaged	Disconnect and store battery in a safe location and recycle or dispose of as soon as possible according to local rules. Contact Ristretto Support to replace the battery.
Wiring damaged	Replace
Battery non-functional	Replace battery

Wheel or motor makes strange noises:

Loose motor cable connection	Reconnect cable
Damaged wheel spokes or rim	Repair or replace
Damaged motor wiring	Replace motor

I Pre-Ride Checklist

Check Battery Charge Level

- Turn on your bike and ensure it is sufficiently charged for your journey.

Check Throttle

- Keep eBike in assist level 0, open the throttle & check that the “Throttle In” voltage on your app’s home page changes.

Check Pedal Assist

- Keep ebike in assist level 0, turn crank arms & check that the “Average Pedal RPM” reading on your app’s home page changes.

Check Fasteners

- Check the bike’s fasteners and components.

Check Tire Pressure | Tire Pressure Gauge

- Check the tire pressure is within the range specified by the manufacturer.

 Air pressure range limits can be found on the sidewall of the tire. Fill or release air as necessary.

Check Wheel Tightness

- Check that each wheel’s axle nuts are tight and there is no wheel wobble. Tighten as needed.

Inspect Brakes

- While rolling your bike beside you, pull on one of the brake levers.
- The bike should come to a stop immediately. Repeat with the other lever.

Check Headset

- Pull the front brake and rock the bike forward and backward.
- There should be no movement in the handlebar mount. Tighten if needed and re-test.

Clean & Lube Chain | Chain Lube & Rag

- With your bike tires off the floor, grasp the chain between the back gears and pedals with a clean rag.
- Spin the pedals a few times so that the chain runs a few cycles through the rag, cleaning off any dirt.
- Apply chain lube as instructed by the lube manufacturer.

| Post-Ride Checklist

Inspect Tires & Rims

- Look for debris and damage on the rims and tires.

Check Wheel Straightness

- Turn each wheel while looking straight down at the tire.
- The wheel should spin true, there should be no wobble.

Check Shifter & Derailleur

- Check the derailleur for any debris.
- With your bike tires off the floor, turn the pedals and shift through the gears.
- Each gear should shift seamlessly.

Wipe Down Frame | Clean, Damp Microfiber Cloth

- Take a rag and wipe the frame of the bike.
- Inspect for any damage or cracks.

Wipe Down Chain | Clean Microfiber Cloth

- With the tires of your bike off the floor, grasp the chain with the cloth and spin the pedals a few times so the chain runs through the cloth.

Check Pedals

- Check both pedals for any damage or loose bearings.

Charge Battery | Battery Charger

- Wait at least one hour after a ride for the battery pack to cool down.
- Once cooled to room temperature, charge the battery pack using the charging instructions noted in this book.
- We recommend charging the battery pack to 80% capacity to increase pack life longevity.

Maintenance Checklists

WEEKLY CHECKLIST

- Clean and lubricate drivetrain; chain, chainrings, cassette, and derailleur pulley.
- Check crankset.
- Inspect brake pads.
- Inspect steering system.
- Inspect wheels.

MONTHLY CHECKLIST

- Check for water damage.
- Wipe down and lubricate suspension sliders and gear shifting cable.
- Degrease and lubricate the chain, chainring, and cassette.
- Lubricate all other drivetrain elements i.e. the derailleur and chain.
- Check condition of all wires and connectors.

SIX MONTH CHECKLIST

- Adjust brakes to ensure proper functionality.
- Adjust gear shifter to ensure power functionality.
- Lubricate gear shifting system.
- Ensure the drivetrain is working as normal.
- True wheels.
- Check all hardware and bearing systems.

I Limited Warranty & Other Terms

Your electric bike warranty and other binding legal terms (e.g., terms of purchase, etc.) are subject to change at any time. To view your terms of purchase, visit ristrettoelectric.com/terms-conditions. To view the current warranty, please visit ristrettoelectric.com/warranty or scan the QR code below for more details.

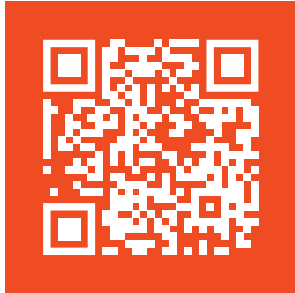

RISTRETTO ONE-YEAR LIMITED WARRANTY **Model(s) Covered: 303FS Founders Edition**

Our goal at Ristretto is to ensure that you are 100% satisfied with your order and purchase. We stand behind our product and guarantee the quality of our electric bikes. All Ristretto Electric Bikes delivered on July 1, 2022, come with a one-year limited warranty including coverage of the 303FS Founders Edition Bike Motor and Lithium Battery.

REGISTER FOR YOUR WARRANTY AT RISTRETTOELECTRIC.COM/WARRANTY

303FS BIKE MOTOR

One-Year Limited Warranty of Ristretto 303FS Founders Edition Bike Motor: Ristretto Electric LLC (RISTRETTO) warrants that all new 303FS Founders Edition Bikes and SELECTED components are warranted to the original client (PURCHASER) against production/manufacturing defects in materials and/or workmanship for a period of (1) year from the original shipping date. Man-made failures are excluded from our warranty. This warranty is limited to the repair or replacement of the original defective motor and is the sole remedy of the warranty. This warranty extends from the original ship date of July 1, 2022 for one-year and applies only to the original owner and is non-transferrable.

303FS BATTERY

One-Year Limited Warranty of 303FS Founders Edition Battery Components: Ristretto Electric LLC (RISTRETTO) warrants to the original PURCHASER that the battery is free of defects in material and workmanship for a period of one (1) year from the date of original ship date.

The defective product will be replaced or repaired if met under certain pre-conditions. This warranty is limited to the repair or replacement of the original defective battery and is the sole remedy of the warranty. This warranty extends from the original ship date of July 1, 2022 for one-year and applies only to the original owner and is non-transferrable.

HOW TO MAKE A WARRANTY CLAIM

The PURCHASER must reach out to Ristretto and provide an electronic invoice (proof of purchase) including the order number, email address, phone number and original FULL NAME used at the time of purchase. (NOTE: All of these requirements must be provided to RISTRETTO for processing warranty claims).

REGISTER FOR YOUR WARRANTY AT [RISTRETTOELECTRIC.COM/WARRANTY](https://ristrettoelectric.com/warranty)

GENERAL DISCLAIMER

Part or model specifications are subject to change without notice.

This Limited Warranty is the only warranty for the product. ALL WARRANTIES OTHER THAN STATED HEREIN ARE DISCLAIMED INCLUDING IMPLIED WARRANTIES OF MERCHANTABILITY AND FITNESS FOR A PARTICULAR PURPOSE, TO THE EXTENT ALLOWABLE BY APPLICABLE LAW. ALL LIABILITY FOR INCIDENTAL, PUNITIVE, SPECIAL, OR CONSEQUENTIAL DAMAGES ARE EXPRESSLY DISCLAIMED, TO THE EXTENT ALLOWABLE BY APPLICABLE LAW.

The only uses for this product are described in this manual.



Contact Us

Email: info@ristrettoelectric.com

Website: ristrettoelectric.com

Owner's Handbook: ristrettoelectric.com/ownershandbook

Ristretto Electric Help Center: ristrettoelectric.com/helpcenter

For additional help you can also view the Ristretto Assembly Video available in the Ristretto Help Center at www.ristrettoelectric.com/helpcenter

Stay Electric

ristrettoelectric.com